

# Cable Tie Mount TR-TD

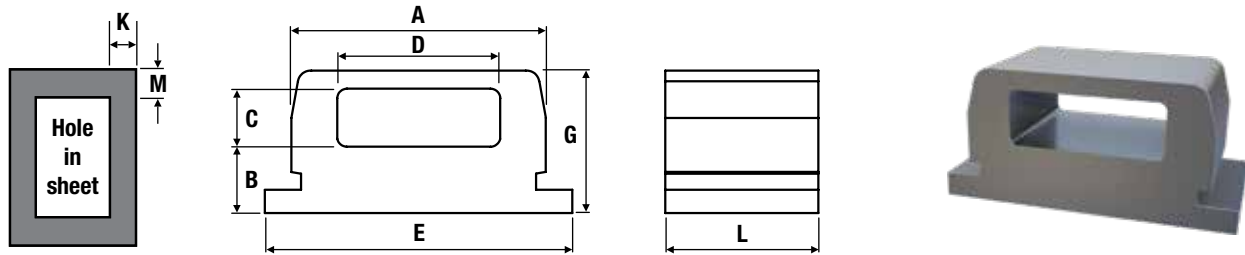

## Metric Dimensions

Zinc Plated Steel: TR-TD

Type	TD - 40	TD - 60	TD - 175
Length code	4	6	12
L $\pm 0.08$	3.07	4.67	9.42
Sheet thickness	1.02 - 1.27	1.02 - 1.78	1.02 - 3.18
Hole size in sheet $+0.05 -0.03$	6.35 x 3.18	7.93 x 4.75	12.70 x 9.53
A $\pm 0.08$	6.25	7.82	12.60
B $\pm 0.15$	1.40	1.91	3.30
C $\pm 0.15$	1.65	1.65	2.40
D $\pm 0.15$	4.06	5.21	9.14
E $\pm 0.15$	7.82	9.40	14.28
Height G $\pm 0.15$	3.81	4.57	7.24
Min. hole edge - sheet edge (M)	1.02		
Min. hole edge - sheet edge (K)	3.73	4.98	6.65

## Metric Performance Data

Part number	TR-TD-40-4	TR-TD-60-6	TR-TD-175-12
Test sheet material	Steel		
Installation (kN)	8	11	17.7
Push-out (kN)	780	1160	1560
Pull through (N)	445	712	780
Side load (N)	400	445	620

TR-TD - Recommended for use in sheet hardness: HRB 60 or less

