

SUPPORTI SPECIFICI PER OGNI MODELLO DI MATRICE REGOLABILE
SPECIFIC HOLDER FOR EACH ADJUSTABLE DIE HOLDER

PER MATRICE 3190 / FOR DIE 3190

9015

3000 mm	120,0 kg
---------	----------

9018

2000 mm	80,0 kg
1000 mm	40,0 kg
500 mm	20,0 kg

SPECIFICO PER ATTACCO WILA / TRUMPF
WILA/TRUMPF DEDICATED TANG

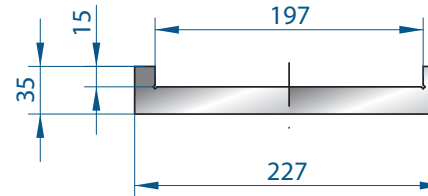

PER MATRICE 3191 / FOR DIE 3191

9016

3000 mm	318,0 kg
---------	----------

9019

2000 mm	212,0 kg
1000 mm	106,0 kg
500 mm	53,0 kg

SPECIFICO PER ATTACCO WILA / TRUMPF
WILA/TRUMPF DEDICATED TANG

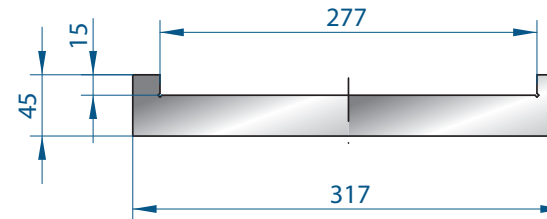

PER MATRICE 3192 / FOR DIE 3192

9014

3000 mm	594,0 kg
2400 mm	396,0 kg
1200 mm	198,0 kg
600 mm	99,0 kg

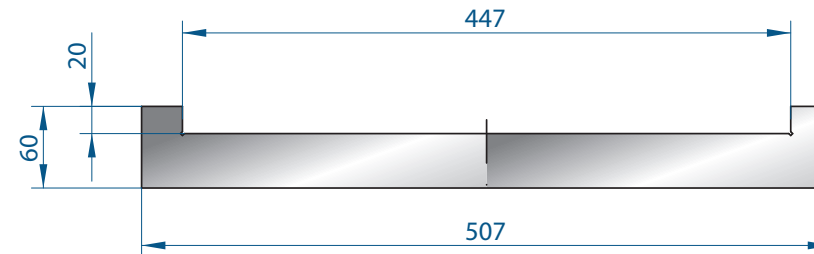

PER MATRICE 3243 / FOR DIE 3243

9017

3000 mm	900,0 kg
2400 mm	600,0 kg
1200 mm	300,0 kg
600 mm	150,0 kg

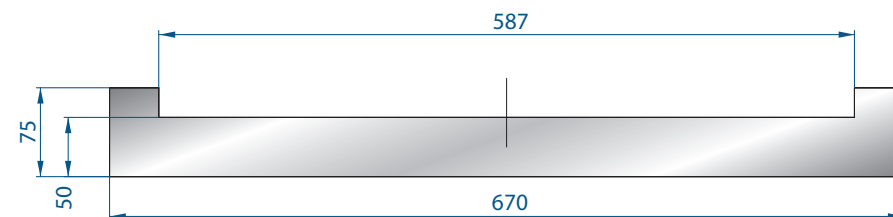

OGNI MODELLO DI MATRICI RICHIEDE UNO SPECIFICO SUPPORTO
EACH DIE REQUIRES THE PROPER SUPPORT"

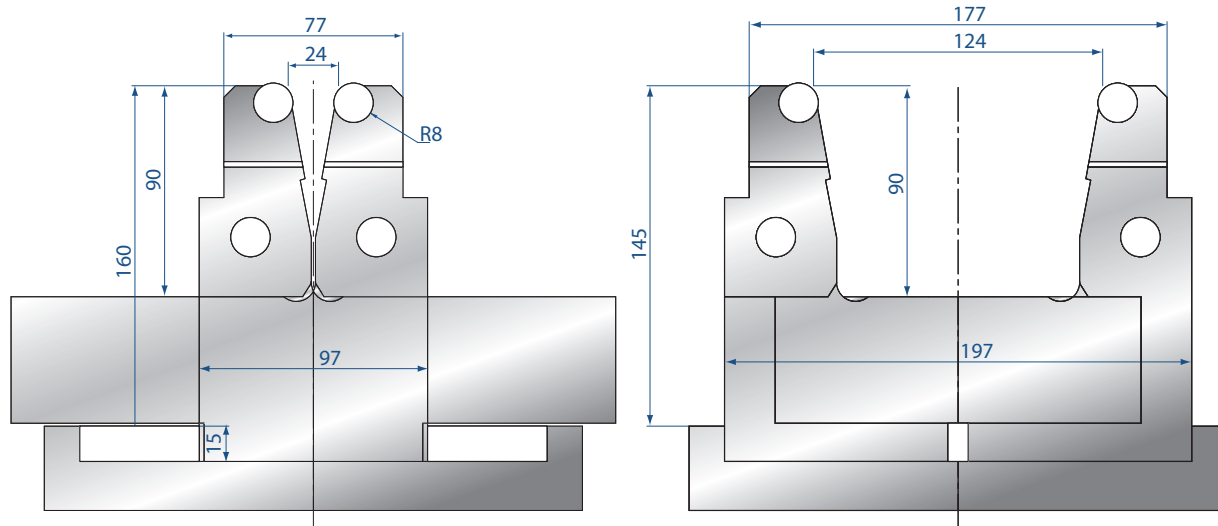

9015 / 9018 (pag 62)

3190 Angolo di piega massima = 60°

V = da 24 a 124

Max = 125 T/m a 90°

Maximum bending angle = 60°

V = from 24 to 124

Max = 125 T/m at 90°

1050 mm	133,0 kg
1000 mm	125,0 kg
550 mm	72,0 kg
500 mm	64,0 kg
250 mm	34,0 kg

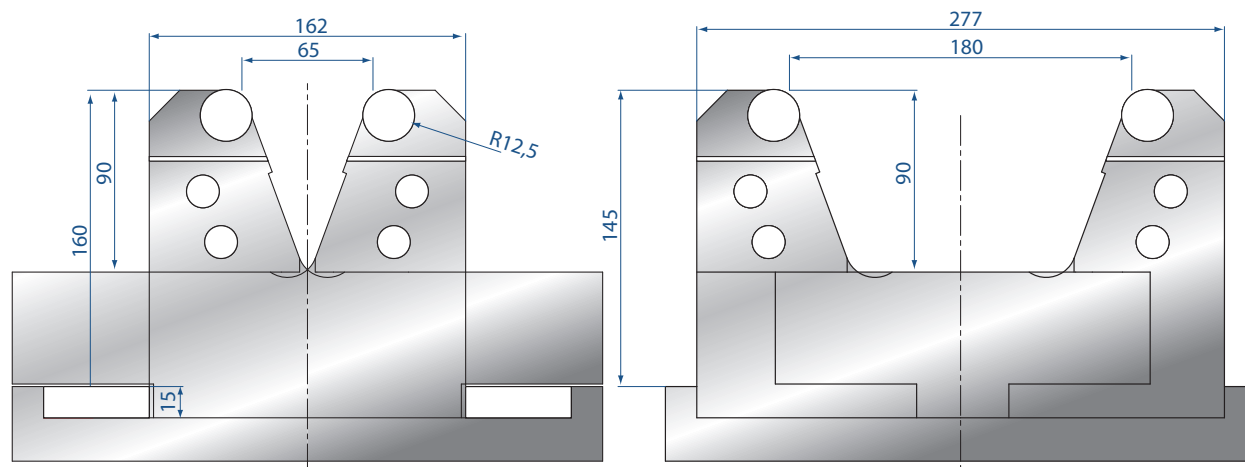

9016 / 9019 (pag 62)

3191 Angolo di piega massima = 60°

V = da 60 a 180

Max = 200 T/m a 90°

Maximum bending angle = 60°

V = from 60 to 180

Max = 200 T/m at 90°

1050 mm	180,0 kg
1000 mm	170,0 kg
550 mm	96,0 kg
500 mm	86,0 kg
250 mm	44,0 kg

OGNI MODELLO DI MATRICI RICHIEDE UNO SPECIFICO SUPPORTO
EACH DIE REQUIRES THE PROPER SUPPORT

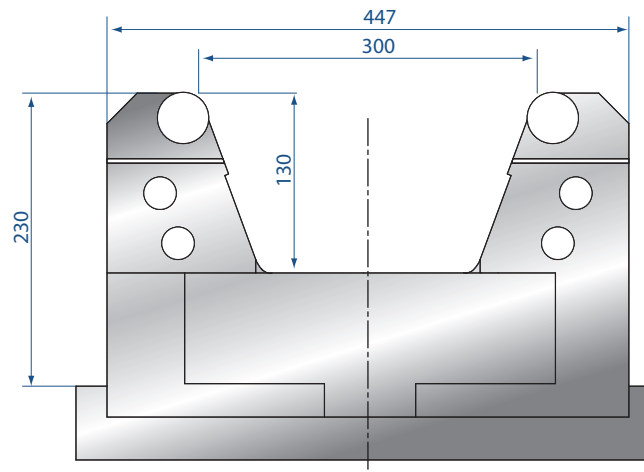
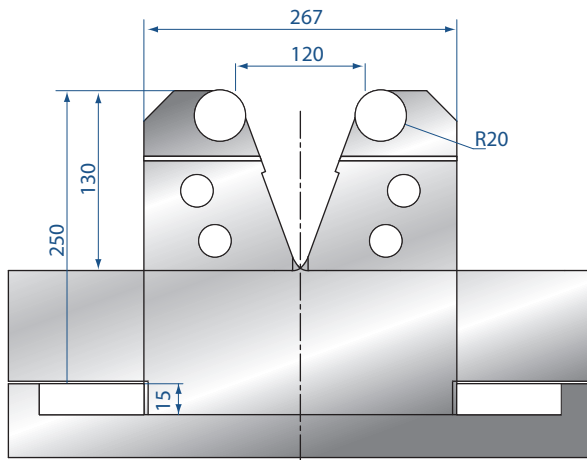

9014 (pag 62)

3192 Angolo di piega massima = 60°
V = da 120 a 300
Max = 400 T/m a 90°
Maximum bending angle = 60°
V = from 120 to 300
Max = 400 T/m at 90°

700 mm	420,0 kg
600 mm	360,0 kg
500 mm	300,0 kg

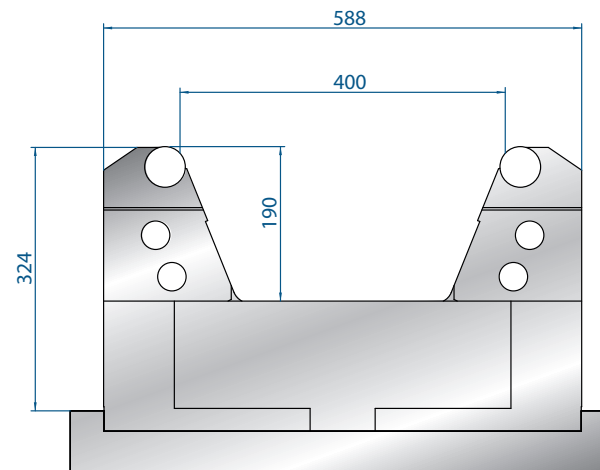
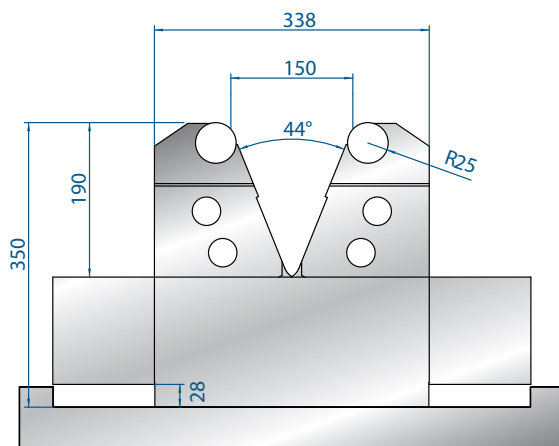

9017 (pag 62≤)

3243 Angolo di piega massima = 60°
V = da 150 a 400
Max = 400 T/m a 90°
Maximum bending angle = 60°
V = from 150 to 400
Max = 400 T/m at 90°

600 mm	560,0 kg
--------	----------



