

# Slotted Panel Fastener TR-PFS2/TR-PFC2

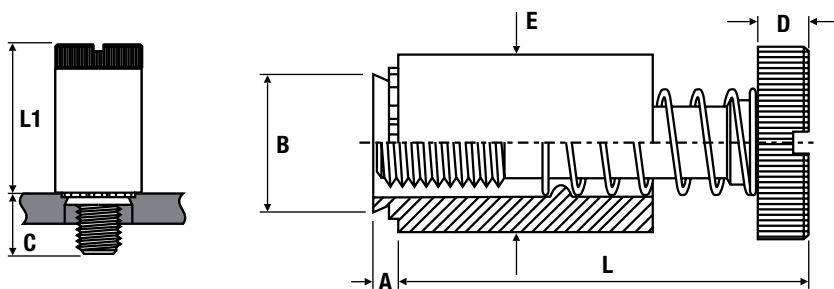

## Metric Dimensions

Zinc Plated Steel: TR-PFS2 | Stainless Steel: TR-PFC2

Thread	M3		M4			M5			M6		
Screw length code	40	62	50	72	94	50	72	94	60	82	04
A max.	1.53		1.53			1.53			1.53		
B max.	6.71		7.9			8.72			10.47		
C ±0.4	6.4	9.5	7.9	11.1	14.3	7.9	11.1	14.3	9.5	12.7	15.9
D ±0.13	1.83		2.08			2.08			2.46		
E ±0.25	7.92		9.53			10.31			11.89		
L nom.	13.72		17.53			17.53			22.35		
L1 max.	9.14		11.43			11.47			14.73		
Min. sheet thickness	1.53		1.53			1.53			1.53		
Recommended hole size +0.08	6.73		7.90			8.74			10.49		
Screw protrusion before installation ±0.64	0	3.2	0	3.2	6.4	0	3.2	6.4	0	3.2	6.4
Min. distance to edge of sheet	6.35		7.87			8.63			9.65		

## Metric Performance Data

Thread	M3	M4	M5	M6
Test sheet material	Steel			
Installation (kN)	13.4	17.0	17.9	22.3
Push-out (N)	1335	1780	2230	2670

TR-PFS2 - Recommended for use in sheet hardness: HRB 80 or less

TR-PFC2 - Recommended for use in sheet hardness: HRB 70 or less



# Cross Recess Panel Fastener TR-PFC2P

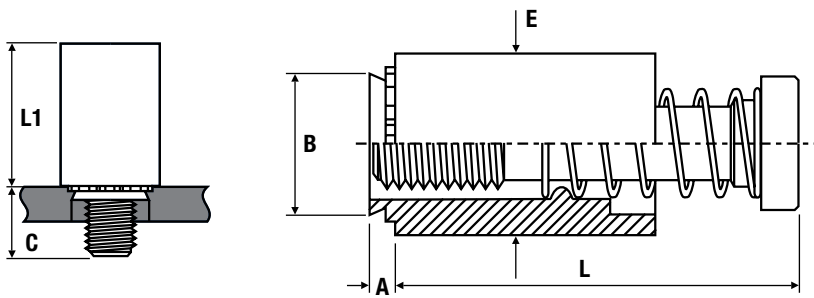

## Metric Dimensions

Stainless Steel: TR-PFC2P

Thread	M3		M4			M5			M6		
Screw length code	40	62	50	72	94	50	72	94	60	82	04
A max.	1.53		1.53			1.53			1.53		
B max.	6.71		7.9			8.72			10.47		
C ±0.4	6.4	9.5	7.9	11.1	14.3	7.9	11.1	14.3	9.5	12.7	15.9
Driver size	PH1		PH2			PH2			PH3		
E ±0.25	7.92		9.53			10.31			11.89		
L nom.	13.72		17.91			17.91			22.99		
L1 max.	9.4		12.19			12.45			15.75		
Min. sheet thickness	1.53		1.53			1.53			1.53		
Recommended hole size +0.08	6.73		7.92			8.74			10.49		
Screw protrusion before installation ±0.64	0	3.2	0	3.2	6.4	0	3.2	6.4	0	3.2	6.4
Min. distance to edge of sheet	6.35		7.87			8.63			9.65		

## Metric Performance Data

Thread	M3	M4	M5	M6
Test sheet material	Steel			
Installation (kN)	13.4	17.0	17.9	22.3
Push-out (N)	1335	1780	2230	2670

TR-PFC2P - Recommended for use in sheet hardness: HRB 70 or less



# Low Profile Panel Fastener TR-PF31/TR-PF32

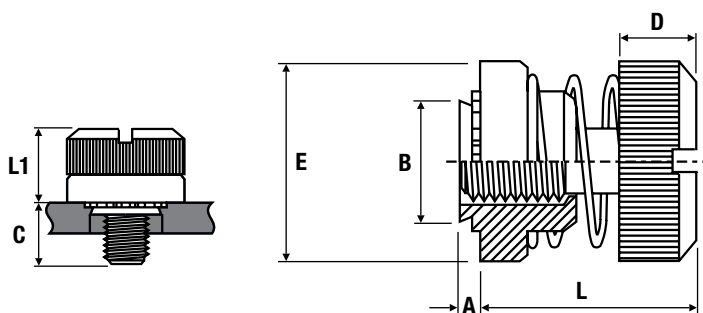

## Metric Dimensions

Nickel Plated Steel: TR-PF31 | Nickel Plated Steel: TR-PF32

Thread	M3		M4		M5		M6
Type	TR-PF31	TR-PF32	TR-PF31	TR-PF32	TR-PF31	TR-PF32	TR-PF32
Screw length code	30		30		30		35
A max.	0.97	1.48	0.97	1.48	0.97	1.48	1.48
Min. sheet thickness	1.0	1.5	1.0	1.5	1.0	1.5	1.5
Recommended hole size +0.08	5.5		6.4		8.0		9.5
B max.	5.48		6.38		7.98		9.48
L nom.	15.11		15.24		15.37		17.15
D ±0.13	5.13		5.26		5.59		6.12
E ±0.25	10.31		11.89		13.46		15.88
C ±0.4	7.62		7.62		7.62		8.89
L1 max.	8.26		8.38		8.51		9.78
Min. distance to edge of sheet	6.6		7.37		8.38		9.65

## Metric Performance Data

Thread	M3	M4	M5	M6
Test sheet material	Aluminium			
Installation (kN)	9.9	12.6	15.6	19.2

TR-PF31 - Recommended for use in sheet hardness: HRB 60 or less

TR-PF32 - Recommended for use in sheet hardness: HRB 60 or less



# Pin Panel Fastener TR-PTL2/TR-PSL2

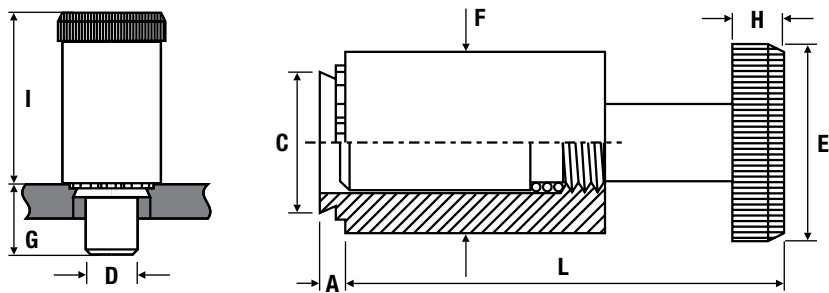

## Metric Dimensions

Zinc Plated Steel: TR-PTL2 | TR-PSL2

Type	TR-PTL2 (locking)	TR-PSL2 (non-locking)
Plunger diameter code	04	04
Plunger length code	4.0	4.0
A max.	1.47	1.47
Min. sheet thickness	1.53	1.53
Recommended hole size +0.08	8.33	8.33
C max.	8.31	8.31
D -0.13	6.35	6.35
E ±0.25	12.7	12.7
F ±0.25	10.3	10.3
G ±0.25	7.87	7.87
H ±0.25	4.32	4.32
I ±0.25	15.11	12.95
L nom.	22.73	19.81
Min. distance to edge of sheet	8.64	8.64

## Metric Performance Data

Type	TR-PTL2 (locking)	TR-PSL2 (non-locking)
Test sheet material	Steel	
Installation (kN)	17.8	17.8
Push-out (N)	2224	2224

TR-PTL2 - Recommended for use in sheet hardness: HRB 80 or less

TR-PSL2 - Recommended for use in sheet hardness: HRB 80 or less



# Captive Screw Panel Fastener TR-PF11

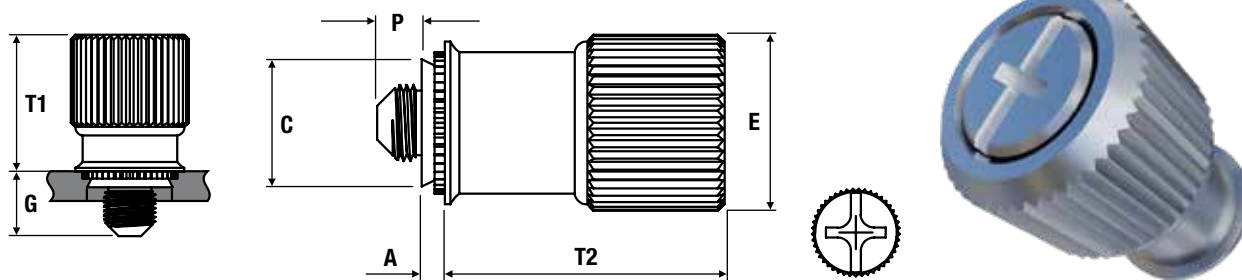

## Metric Dimensions

Nickel Plated Heat Treated Steel (Retainer), Aluminium (Knob), Stainless Steel (Screw & Spring): TR-PF11

Thread	M3			M4			M5			M6
Screw length code	0	1	2	0	1	2	0	1	2	2
A max.	0.92			0.92			0.92			0.92
Min. sheet thickness	0.92			0.92			0.92			0.92
Recommended hole size +0.08	5.56			7.92			7.92			9.53
C max.	5.54			7.90			7.90			9.50
E ±0.25	10.59			13.06			13.06			14.61
G ±0.64	4.32	5.84	7.37	5.84	7.37	8.89	5.84	7.37	8.89	10.41
P ±0.64	0	1.52	3.05	0	1.52	3.05	0	1.52	3.05	3.05
T1 nom.	7.87			11.43			11.43			13.46
T2 nom.	11.43			16.26			16.26			20.07
Driver size	PH1			PH2			PH2			PH3
Min. distance to edge of sheet	7.11			8.38			8.38			11.68

## Metric Performance Data

Thread	M3	M4	M5	M6
Test sheet material	Steel			
Installation (kN)	11.1	20.0	20.0	22.2
Push-out (N)	645	710	710	865

TR-PF11 - Recommended for use in sheet hardness: HRB 80 or less



# Captive Screw Panel Fastener TR-PFHV

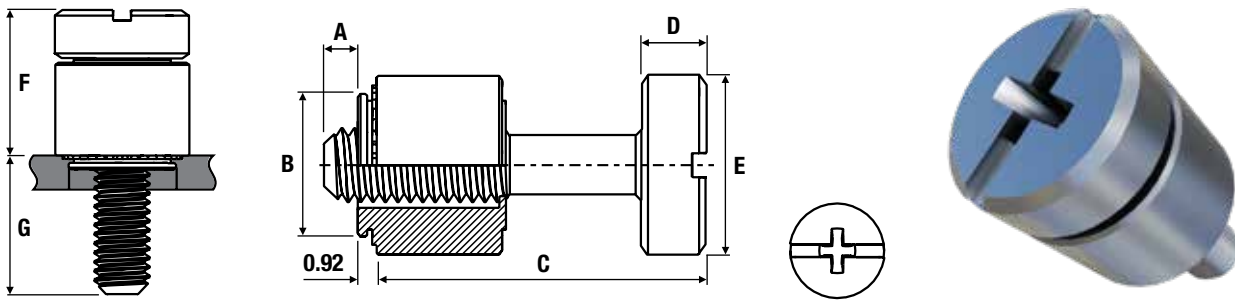

## Metric Dimensions

Zinc Plated Steel: TR-PFHV

Thread	M3		M3.5		M4	
Screw code	0	1	0	1	0	1
A (shank) max.	0	1.9	0	2.30	0	2.7
B max.	5.49		5.98		6.38	
C nom.	11.25		12.47		14.1	
D $\pm 0.13$	2.03		2.34		2.79	
E $\pm 0.25$	6.95		7.45		7.85	
F nom.	6.69		7.45		8.5	
G $\pm 0.64$	5.55	7.56	6.01	8.42	6.59	9.39
Min. sheet thickness	0.92		0.92		0.92	
Recommended hole size +0.08	5.5 - 5.58		6.0 - 6.08		6.4 - 6.48	
Min. distance to edge of sheet	5.8		6.3		6.7	

## Metric Performance Data

Thread	M3	M3.5	M4
Test sheet material	Steel		
Installation (kN)	10.5	11.4	12.1
Push-out (N)	564	614	656

TR-PFHV - Recommended for use in sheet hardness: HRB 60 or less



# Low Profile Cross Recess Panel Fastener TR-PF50

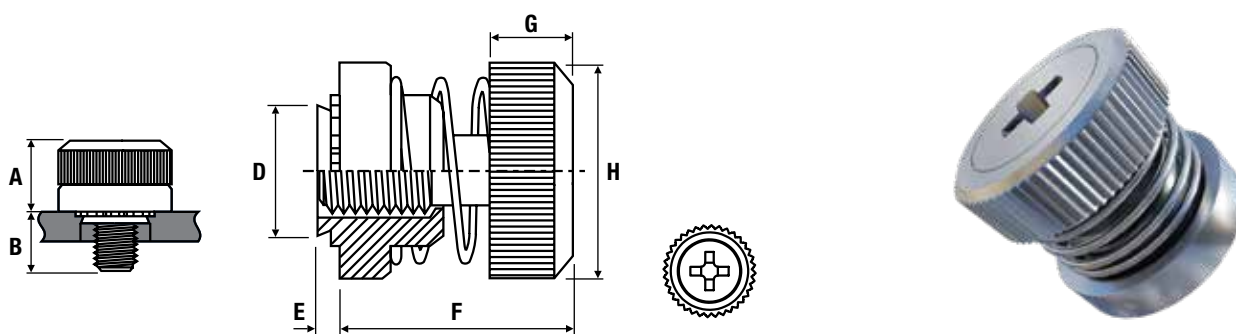

## Metric Dimensions

Zinc Plated Steel: TR-PF50

Thread	M3		M4		M5	
	0	1	0	1	0	1
<b>Screw code</b>						
<b>A max.</b>	8.64		8.64		9.15	
<b>B ±0.64</b>	5.84	7.37	5.84	7.37	5.84	7.37
<b>C min. sheet thickness</b>	0.8		0.8		0.8	
<b>D max.</b>	5.48		6.38		7.98	
<b>E +0.4 / -0.13</b>	0.77		0.77		0.77	
<b>F nom.</b>	13.21		13.46		13.46	
<b>G ±0.2</b>	5.26		5.51		5.72	
<b>H +0.4 / -0.13</b>	10.3		11.9		13.5	
<b>Recommended hole size +0.08</b>	5.5 - 5.58		6.4 - 6.48		8 - 8.08	
<b>Min. distance to edge of sheet</b>	6.6		7.4		8.4	

## Metric Performance Data

Thread	M3	M4	M5
<b>Test sheet material</b>	Steel		
<b>Installation (kN)</b>	22.2	26.7	35.6
<b>Push-out (N)</b>	400	400	423

TR-PF50 - Recommended for use in sheet hardness: HRB 60 or less

[www.trfastenings.com](http://www.trfastenings.com)

Go to our website to view preferred ranges, download 3D models and view installation animations

