



# **FASTENERS FOR SHEET METAL**

[www.trfastenings.com](http://www.trfastenings.com)

**Edition 4**



## Hank® Self Clinch Fasteners

Flush Head Stud - TR-FH/TR-FHS/TR-FHA/TR-FH4	4	Through Standoff - TR-SO/TR-SOS/TR-SOA/TR-SO4	9
Concealed Head Stud for 1.6mm Sheet - TR-CHC/TR-CHA	4	Concealed Head Standoff for 1.6mm Sheet - TR-CSS	10
Concealed Head Stud for 2.4mm Sheet - TR-CFHC/TR-CFHA	4	Concealed Head Standoff for 2.4mm Sheet - TR-CSOS	10
Heavy Duty Stud - TR-HFH/TR-HFHS	4	Hole Slide Standoff - TR-SKC	10
Low Displacement Stud - TR-FHL/TR-FHLS	5	Close To Edge Standoff - TR-DSO/TR-DSOS	10
Broaching Stud - TR-KFH	5	Grounding Standoff - TR-SOSG	11
Thin Sheet Stud - TR-TFH	5	Clip-on Standoff - TR-SSS/TR-SSC/TR-SSA	11
Heavy Duty Thin Sheet Stud - TR-HFE	5	Broaching Through Hole Standoff - TR-KFE/TR-KFSE	11
Nut - TR-S/TR-CLS/TR-CLA/TR-SP4/TR-SP2	6	Broaching Threaded Standoff - TR-KFE/TR-KFSE	11
Flush Nut - TR-F/TR-F4	6	Thin Sheet Standoff - TR-TSO/TR-TSOS	12
Blind Nut - TR-B/TR-BS	6	Clear Hole Standoff - TR-SO	12
Broaching Nut - TR-KF2/TR-KFS2	6	Slotted Panel Fastener - TR-PFS2/TR-PFC2	12
Non-Locking Floating Nut - TR-AS/TR-AC	7	Cross Recess Panel Fastener - TR-PFC2P	12
Locking Floating Nut - TR-LAS/TR-LAC	7	Low Profile Panel Fastener - TR-PF30/TR-PF31/TR-PF32	13
Locking Nut - TR-LK/TR-LKS	7	Pin Panel Fastener - TR-PTL2	13
Nylon Lock Nut - TR-PL/TR-PLC	7	Captive Screw Panel Fastener - TR-PF11	13
Non-Locking Mini Squeezed Nut - TR-U/TR-FEX/TR-FEOX	8	Captive Screw Panel Fastener - TR-PFHV	13
Self-Locking Mini Squeezed Nut - TR-UL/TR-FE/TR-FEO	8	Low Profile Cross Recess Panel Fastener - TR-PF50	14
Thin Sheet Nut - TR-SMPS	8	Flush Head Pin - TR-TP/TR-TPS/TR-TP4	14
Nylon Insert Broaching Nut - TR-CFN	8	Terminal Pin - TR-TER	14
Thread Lock Feature Nut - TR-SL	9	Cable Tie Mount - TR-TD	14
Non-Locking H Nut - TR-H	9	EPW Self-Extruding Screw - TR-EPW	15
Blind Standoff - TR-BSO/TR-BSOS/TR-BSOA/TR-BSO4	9		

## Hank® Rivet Bushes

Round Serrated Face	16	Mini Standoff Serrated Face	17
Mini Round Serrated Face	16	Tank	18
Round Serrated Spigot	16	Swage Nut	18
Hexagon	16	Hank-Loc® Round	18
Mini Round Euro	17	Hank-Loc® Mini	18
Round Euro	17	Hank-Loc® Hexagon	19
Standoff Serrated Face	17		

## Blind Rivet Nuts

Knurled Body Reduced Head - Open End	20	Knurled Body Flange Head - Open End	21
Knurled Body Reduced Head - Closed End	20	Knurled Body Flange Head - Closed End	21
Plain Body Reduced Head - Open End	20	Hexagon Body Flange Head - Open End	21
Plain Body Reduced Head - Closed End	20	Knurled Body Countersunk Head - Open End	22
Hexagon Body Reduced Head - Open End	21		





## Blind Rivets

Open Type Dome Head	23	Multi-Grip Type Dome Head	24
Open Type Countersunk Head	23	Multi-Grip Type Countersunk Head	24
Open Type Large Flange Head	23	Multi-Grip Type Large Flange Head	25
Sealed Type Dome Head	23	Peel Type Dome Head	25
Sealed Type Countersunk Head	24	Grooved Type Dome Head	25
Sealed Type Large Flange Head	24		

## Weld Nuts

Hexagon Weld Nut	26	Wun-Loc® Self Locking Weld Nut	26
Square Weld Nut	26		

## K-Series® Nuts

K-Series® Nut	27	K-Series® Thin Nut	27
---------------	----	--------------------	----

## CD Weld Studs

Threaded CD Weld Stud	28	Internally Threaded CD Weld Stud	28
Unthreaded CD Weld Stud	28	Coarse Threaded CD Weld Stud	28

## Masking Caps & Plugs

Masking Caps	29	Masking Plugs	29
--------------	----	---------------	----

## Spring Steel Fasteners

Cage Nut	30	Flat Nut	30
U Nut	30	Torque Nut	31
J Nut	30	Multi Thread U Nut	31

## Solid & Tubular Rivets

Round Head Solid Rivet	32	Countersunk Head Solid Rivet	32
Flat Round Head Solid Rivet	32	Tubular Rivet	32

## Flush Head Stud TR-FH/TR-FHS/TR-FHA/TR-FH4

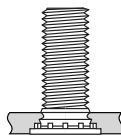
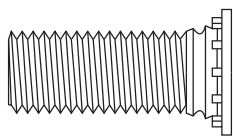
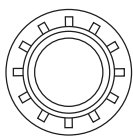

Category: Self Clinch Fastener  
Product: Stud  
Type: Flush Head  
Material: Steel (TR-FH), Stainless Steel (TR-FHS), Aluminium (TR-FHA), 400 Stainless Steel (TR-FH4)  
Thread: M2, M2.5, M3, M4, M5, M6, M8



[www.trfastenings.com/TR00028536](http://www.trfastenings.com/TR00028536)

## Concealed Head Stud for 1.6mm Sheet TR-CHC/TR-CHA

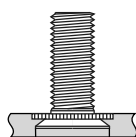
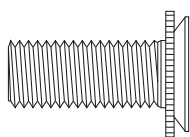
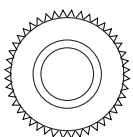

Category: Self Clinch Fastener  
Product: Stud  
Type: Concealed Head  
Material: Stainless Steel (TR-CHC), Aluminium (TR-CHA)  
Thread: M3, M4, M5



[www.trfastenings.com/TR00028454](http://www.trfastenings.com/TR00028454)

## Concealed Head Stud for 2.4mm Sheet TR-CFHC/TR-CFHA

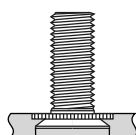
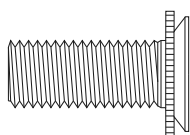
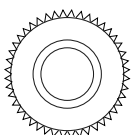

Category: Self Clinch Fastener  
Product: Stud  
Type: Concealed Head  
Material: Stainless Steel (TR-CFHC), Aluminium (TR-CFHA)  
Thread: M3, M4, M5



[www.trfastenings.com/TR00028495](http://www.trfastenings.com/TR00028495)

## Heavy Duty Stud TR-HFH/TR-HFHS

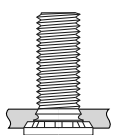
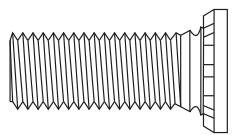
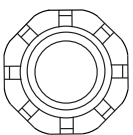

Category: Self Clinch Fastener  
Product: Stud  
Type: Heavy Duty  
Material: Steel (TR-HFH), Stainless Steel (TR-HFHS)  
Thread: M5, M6, M8, M10



[www.trfastenings.com/TR00029165](http://www.trfastenings.com/TR00029165)





## Low Displacement Stud TR-FHL/TR-FHLS

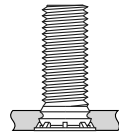
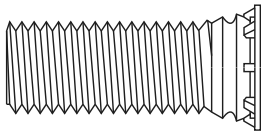
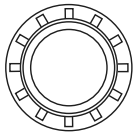

Category: Self Clinch Fastener  
Product: Stud  
Type: Low Displacement  
Material: Steel (TR-FHL), Stainless Steel (TR-FHLS)  
Thread: M2.5, M3, M4, M5



[www.trfastenings.com/TR00029270](http://www.trfastenings.com/TR00029270)

## Broaching Stud TR-KFH

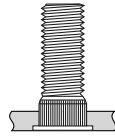
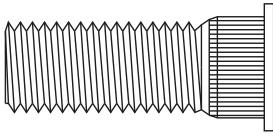
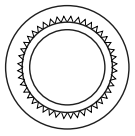

Category: Self Clinch Fastener  
Product: Stud  
Type: Broaching  
Material: Phosphor Bronze (TR-KFH)  
Thread: M2.5, M3, M4, M5



[www.trfastenings.com/TR00028436](http://www.trfastenings.com/TR00028436)

## Thin Sheet Stud TR-TFH

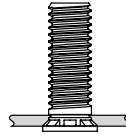
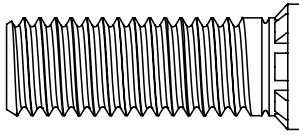
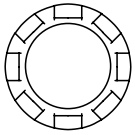

Category: Self Clinch Fastener  
Product: Stud  
Type: Thin Sheet  
Material: Steel (TR-TFH)  
Thread: M3, M4, M5



[www.trfastenings.com/TR00029427](http://www.trfastenings.com/TR00029427)

## Heavy Duty Thin Sheet Stud TR-HFE

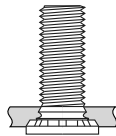
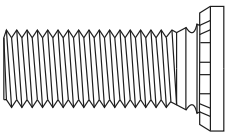
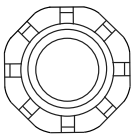

Category: Self Clinch Fastener  
Product: Stud  
Type: Heavy Duty Thin Sheet  
Material: Steel (TR-HFE)  
Thread: M5, M6, M8



[www.trfastenings.com/TR00038778](http://www.trfastenings.com/TR00038778)



## Nut TR-S/TR-CLS/TR-CLA/TR-SP4/TR-SP2

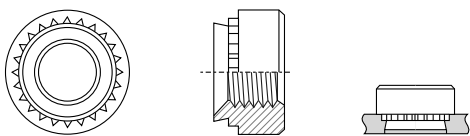

Category: Self Clinch Fastener  
Product: Nut  
Type: Nut  
Material: Steel (TR-S), Stainless Steel (TR-CLS), Aluminium (TR-CLA), 400 Stainless Steel (TR-SP4), A286 Stainless Steel (TR-SP2)  
Thread: M2, M2.5, M3, M3.5, M3 Alt, M4, M5, M6, M8, M10, M12



[www.trfastenings.com/TR00029909](http://www.trfastenings.com/TR00029909)

## Flush Nut TR-F/TR-F4

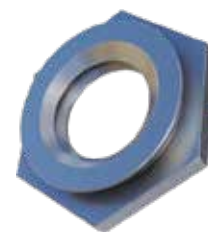
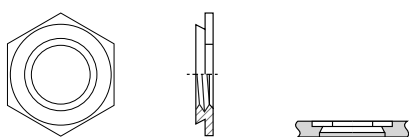

Category: Self Clinch Fastener  
Product: Nut  
Type: Flush  
Material: Stainless Steel (TR-F), 400 Series Stainless Steel (TR-F4)  
Thread: M2, M2.5, M3, M3.5, M3 Alt, M4, M5, M6



[www.trfastenings.com/TR00029891](http://www.trfastenings.com/TR00029891)

## Blind Nut TR-B/TR-BS

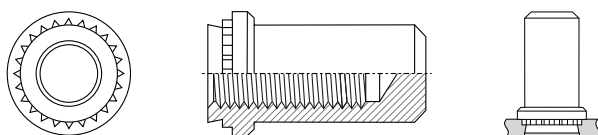

Category: Self Clinch Fastener  
Product: Nut  
Type: Blind  
Material: Steel (TR-B), Stainless Steel (TR-BS)  
Thread: M3, M4, M5, M6



[www.trfastenings.com/TR00029825](http://www.trfastenings.com/TR00029825)

## Broaching Nut TR-KF2/TR-KFS2

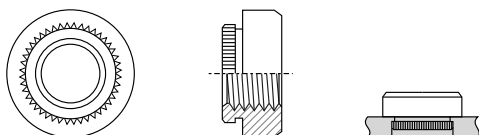

Category: Self Clinch Fastener  
Product: Nut  
Type: Broaching  
Material: Steel (TR-KF2), Stainless Steel (TR-KFS2)  
Thread: M2, M2.5, M3, M3.5, M4, M5



[www.trfastenings.com/TR00029866](http://www.trfastenings.com/TR00029866)



## Non-Locking Floating Nut TR-AS/TR-AC

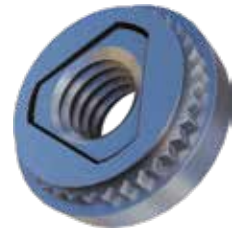
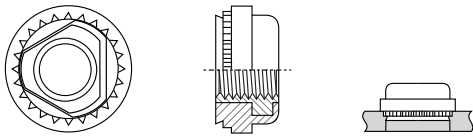

Category: Self Clinch Fastener  
Product: Nut  
Type: Non-Locking Floating  
Material: Steel (TR-AS), Stainless Steel (TR-AC)  
Thread: M3, M4, M5, M6



[www.trfastenings.com/TR00026768](http://www.trfastenings.com/TR00026768)

## Locking Floating Nut TR-LAS/TR-LAC

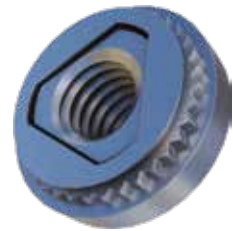
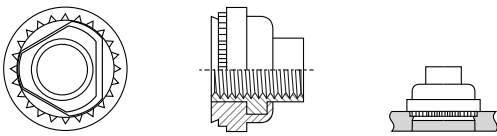

Category: Self Clinch Fastener  
Product: Nut  
Type: Locking Floating Nut  
Material: Steel (TR-LAS), Stainless Steel (TR-LAC)  
Thread: M3, M4, M5, M6



[www.trfastenings.com/TR00026731](http://www.trfastenings.com/TR00026731)

## Locking Nut TR-LK/TR-LKS

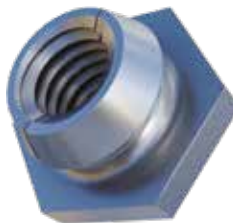
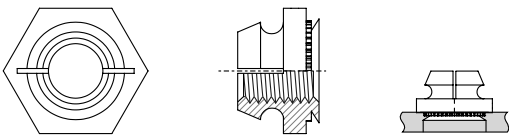

Category: Self Clinch Fastener  
Product: Nut  
Type: Locking  
Material: Steel (TR-LK), Stainless Steel (TR-LKS)  
Thread: M2.5, M3, M4, M5



[www.trfastenings.com/TR00030200](http://www.trfastenings.com/TR00030200)

## Nylon Lock Nut TR-PL/TR-PLC

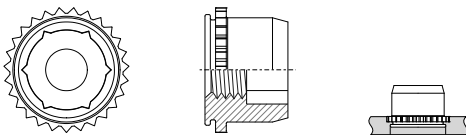

Category: Self Clinch Fastener  
Product: Nut  
Type: Nylon Lock Nut  
Material: Steel (TR-PL), Stainless Steel (TR-PLC)  
Thread: M3, M4, M5



[www.trfastenings.com/TR00030217](http://www.trfastenings.com/TR00030217)



## Non-Locking Mini Squeezed Nut TR-U/TR-FEX/TR-FEOX

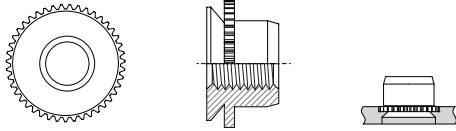

Category: Self Clinch Fastener  
Product: Nut  
Type: Non-Locking Mini Squeezed  
Material: Steel (TR-U/TR-FEX/TR-FEOX)  
Thread: M2, M3, M4, M5, M6



[www.trfastenings.com/TR00030224](http://www.trfastenings.com/TR00030224)

## Self-Locking Mini Squeezed Nut TR-UL/TR-FE/TR-FEO

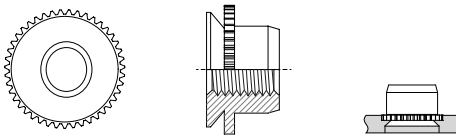

Category: Self Clinch Fastener  
Product: Nut  
Type: Self-Locking Mini Squeezed  
Material: Stainless Steel (TR-UL/TR-FE/TR-FEO)  
Thread: M2, M3, M4, M5, M6



[www.trfastenings.com/TR00030233](http://www.trfastenings.com/TR00030233)

## Thin Sheet Nut TR-SMPS

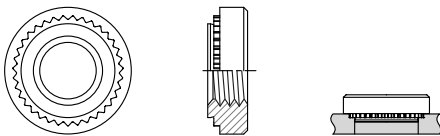

Category: Self Clinch Fastener  
Product: Nut  
Type: Thin Sheet  
Material: Steel (TR-SMPS)  
Thread: M2.5, M3, M3.5



[www.trfastenings.com/TR00039596](http://www.trfastenings.com/TR00039596)

## Nylon Insert Broaching Nut TR-CFN

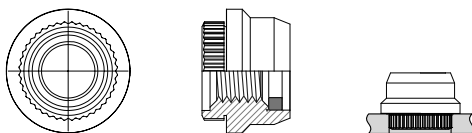

Category: Self Clinch Fastener  
Product: Nut  
Type: Nylon Insert Broaching  
Material: Steel (TR-CFN)  
Thread: M3



[www.trfastenings.com/TR00044323](http://www.trfastenings.com/TR00044323)





## Thread Lock Feature Nut TR-SL

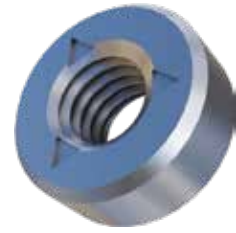
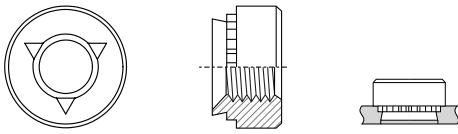

Category: Self Clinch Fastener  
Product: Nut  
Type: Thread Lock Feature  
Material: Steel (TR-SL)  
Thread: M3, M3.5, M4, M5, M6, M8



[www.trfastenings.com/TR00044325](http://www.trfastenings.com/TR00044325)

## Non-Locking H Nut TR-H

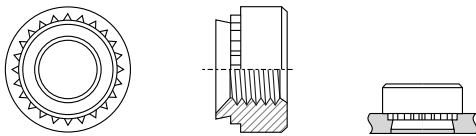

Category: Self Clinch Fastener  
Product: Nut  
Type: Non-Locking H  
Material: Steel (TR-H)  
Thread: M10



[www.trfastenings.com/TR00039594](http://www.trfastenings.com/TR00039594)

## Blind Standoff TR-BS0/TR-BS0S/TR-BS0A/TR-BS04

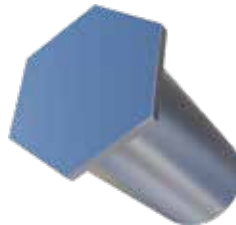
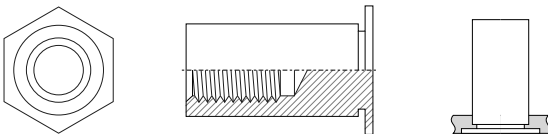

Category: Self Clinch Fastener  
Product: Standoff  
Type: Blind  
Material: Steel (TR-BS0), Stainless Steel (TR-BS0S), Aluminium (TR-BS0A), 400 Stainless Steel (TR-BS04)  
Thread: M2, M2.5, M3, M3 Alt, M4, M5



[www.trfastenings.com/TR00026983](http://www.trfastenings.com/TR00026983)

## Through Standoff TR-S0/TR-S0S/TR-S0A/TR-S04

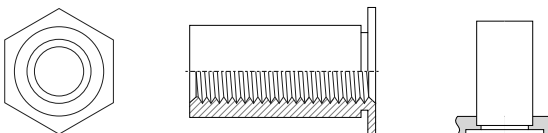

Category: Self Clinch Fastener  
Product: Standoff  
Type: Through  
Material: Steel (TR-S0), Stainless Steel (TR-S0S), Aluminium (TR-S0A), 400 Stainless Steel (TR-S04)  
Thread: M2, M2.5, M3, M3 Alt, M4, M5



[www.trfastenings.com/TR00027907](http://www.trfastenings.com/TR00027907)



## Concealed Head Standoff for 1.6mm Sheet TR-CSS

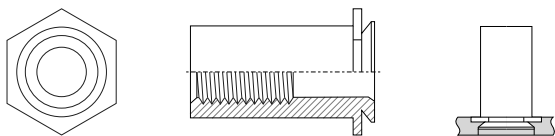

Category: Self Clinch Fastener  
Product: Standoff  
Type: Concealed Head for 1.6mm Sheet  
Material: Stainless Steel (TR-CSS)  
Thread: M3, M4, M5

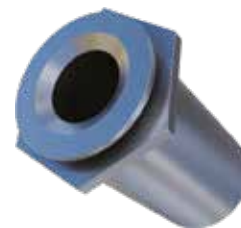

[www.trfastenings.com/TR00027804](http://www.trfastenings.com/TR00027804)

## Concealed Head Standoff for 2.4mm Sheet TR-CSOS

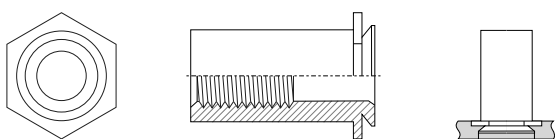

Category: Self Clinch Fastener  
Product: Standoff  
Type: Concealed Head for 2.4mm min. Sheet  
Material: Stainless Steel (TR-CSOS)  
Thread: M3, M4, M5, M6

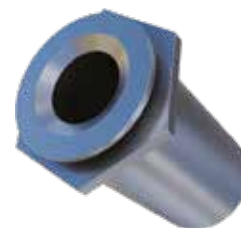

[www.trfastenings.com/TR00027822](http://www.trfastenings.com/TR00027822)

## Hole Slide Standoff TR-SKC

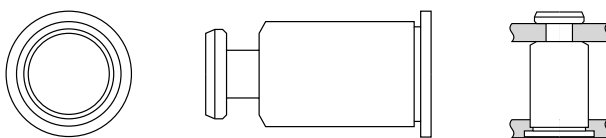

Category: Self Clinch Fastener  
Product: Standoff  
Type: Hole Slide  
Material: Stainless Steel (TR-SKC)  
Dia. Code: 61.5



[www.trfastenings.com/TR00027851](http://www.trfastenings.com/TR00027851)

## Close To Edge Standoff TR-DSO/TR-DSOS

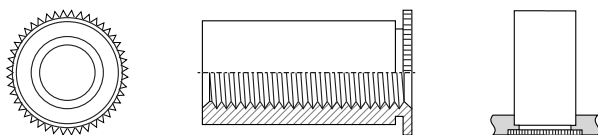

Category: Self Clinch Fastener  
Product: Standoff  
Type: Close To Edge  
Material: Steel (TR-DSO), Stainless Steel (TR-DSOS)  
Thread: M3



[www.trfastenings.com/TR00027898](http://www.trfastenings.com/TR00027898)



## Grounding Standoff TR-SOSG

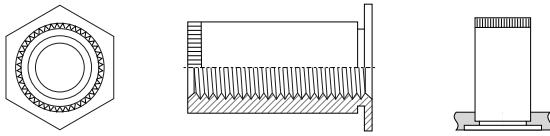

Category: Self Clinch Fastener  
Product: Standoff  
Type: Grounding  
Material: Stainless Steel (TR-SOSG)  
Thread: M3



[www.trfastenings.com/TR00027844](http://www.trfastenings.com/TR00027844)

## Clip-on Standoff TR-SSS/TR-SSC/TR-SSA

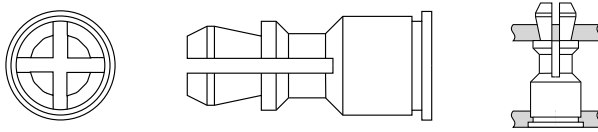

Category: Self Clinch Fastener  
Product: Standoff  
Type: Clip-on  
Material: Steel (TR-SSS), Stainless Steel (TR-SSC), Aluminium (TR-SSA)



[www.trfastenings.com/TR00027722](http://www.trfastenings.com/TR00027722)

## Broaching Through Hole Standoff TR-KFE/TR-KFSE

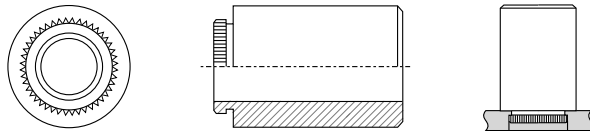

Category: Self Clinch Fastener  
Product: Standoff  
Type: Broaching Through Hole  
Material: Steel (TR-KFE), Stainless Steel (TR-KFSE)  
Dia.: 3.6mm, 4.2mm



[www.trfastenings.com/TR00027617](http://www.trfastenings.com/TR00027617)

## Broaching Threaded Standoff TR-KFE/TR-KFSE

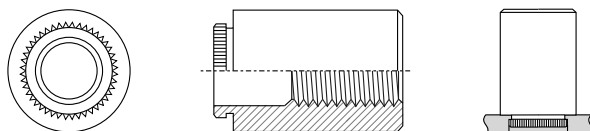

Category: Self Clinch Fastener  
Product: Standoff  
Type: Broaching Threaded  
Material: Steel (TR-KFE), Stainless Steel (TR-KFSE)  
Thread: M3, M4



[www.trfastenings.com/TR00027512](http://www.trfastenings.com/TR00027512)



## Thin Sheet Standoff TR-TSO/TR-TSOS

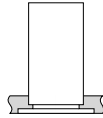
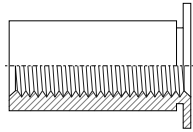
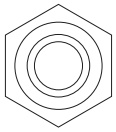

Category: Self Clinch Fastener  
Product: Standoff  
Type: Thin Sheet  
Material: Steel (TR-TSO), Stainless Steel (TR-TSOS)  
Thread: M2.5, M2.5 Alt, M3, M3.5, M3 Alt



[www.trfastenings.com/TR00029582](http://www.trfastenings.com/TR00029582)

## Clear Hole Standoff TR-S0

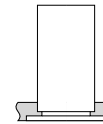
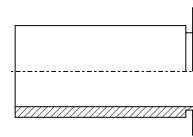
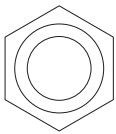

Category: Self Clinch Fastener  
Product: Standoff  
Type: Clear Hole  
Material: Steel (TR-S0)  
Dia.: 4/3.1mm, 6/3.1mm, 6/3.6mm, 8/3.6mm, 8/4.1mm, 8/5.1mm



[www.trfastenings.com/TR00038794](http://www.trfastenings.com/TR00038794)

## Slotted Panel Fastener TR-PFS2/TR-PFC2

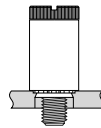
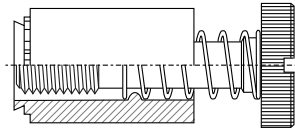

Category: Self Clinch Fastener  
Product: Panel Fastener  
Type: Slotted  
Material: Steel (TR-PFS2), Stainless Steel (PFC2)  
Thread: M3, M4, M5, M6



[www.trfastenings.com/TR00026861](http://www.trfastenings.com/TR00026861)

## Cross Recess Panel Fastener TR-PFC2P

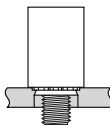
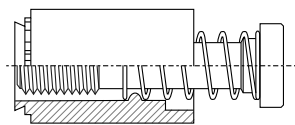

Category: Self Clinch Fastener  
Product: Panel Fastener  
Type: Cross Recess  
Material: Stainless Steel (TR-PFC2P)  
Thread: M3, M4, M5, M6



[www.trfastenings.com/TR00026805](http://www.trfastenings.com/TR00026805)



Hank® is a registered trademark of TR Fastenings.

## Low Profile Panel Fastener TR-PF30/TR-PF31/TR-PF32

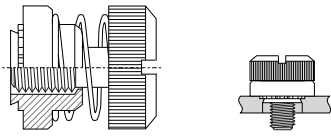

Category: Self Clinch Fastener  
Product: Panel Fastener  
Type: Low Profile  
Material: Steel (TR-PF30/TR-PF31/TR-PF32)  
Thread: M3, M4, M5, M6



[www.trfastenings.com/TR00026834](http://www.trfastenings.com/TR00026834)

## Pin Panel Fastener TR-PTL2

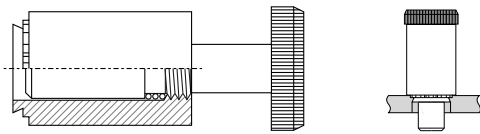

Category: Self Clinch Fastener  
Product: Panel Fastener  
Type: Pin  
Material: Steel (TR-PTL2)  
Dia. Code: 6.35mm (04)



[www.trfastenings.com/TR00026858](http://www.trfastenings.com/TR00026858)

## Captive Screw Panel Fastener TR-PF11

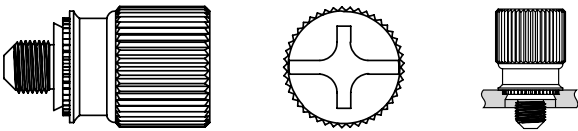

Category: Self Clinch Fastener  
Product: Panel Fastener  
Type: Captive Screw  
Material: Steel, Aluminium, Stainless Steel (TR-PF11)  
Thread: M3, M4, M5, M6



[www.trfastenings.com/TR00029809](http://www.trfastenings.com/TR00029809)

## Captive Screw Panel Fastener TR-PFHV

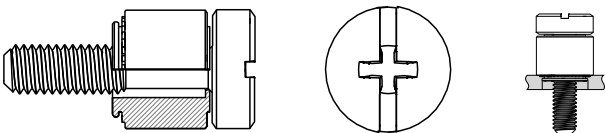

Category: Self Clinch Fastener  
Product: Panel Fastener  
Type: Captive Screw  
Material: Steel (TR-PFHV)  
Thread: M3, M3.5, M4



[www.trfastenings.com/TR00044347](http://www.trfastenings.com/TR00044347)





## Low Profile Cross Recess Panel Fastener TR-PF50

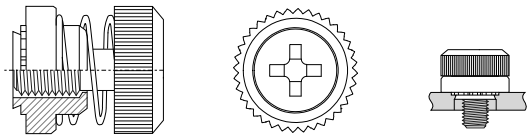

Category: Self Clinch Fastener  
Product: Panel Fastener  
Type: Low Profile Cross Recess  
Material: Steel (TR-PF50)  
Size: M3, M4, M5



[www.trfastenings.com/TR00046710](http://www.trfastenings.com/TR00046710)

## Flush Head Pin TR-TP/TR-TPS/TR-TP4

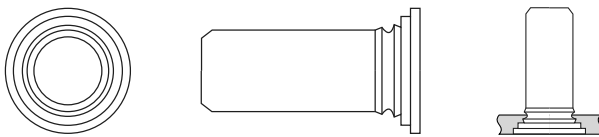

Category: Self Clinch Fastener  
Product: Pin  
Type: Flush Head  
Material: Steel (TR-TP), Stainless Steel (TR-TPS), 400 Stainless Steel (TR-TP4)  
Pin Dia.: 3mm, 4mm, 5mm, 6mm



[www.trfastenings.com/TR00026918](http://www.trfastenings.com/TR00026918)

## Terminal Pin TR-TER

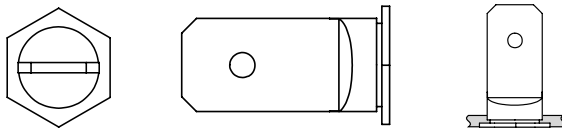

Category: Self Clinch Fastener  
Product: Pin  
Type: Terminal Pin  
Material: Steel (TR-TER)  
Width: 8mm



[www.trfastenings.com/TR00029823](http://www.trfastenings.com/TR00029823)

## Cable Tie Mount TR-TD



Category: Self Clinch Fastener  
Product: Mount  
Type: Cable Tie Mount  
Material: Steel (TR-TD)  
Size: TR-TD-40-4, TR-TD-60-6, TR-TD-175-12



[www.trfastenings.com/TR00029819](http://www.trfastenings.com/TR00029819)



Hank® is a registered trademark of TR Fastenings.

# EPW Self-Extruding Screw TR-EPW

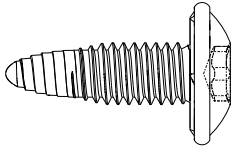

Category: Sheet Metal Fastener  
Product: Self Extruding High Strength Screw for Thin Sheet Metal  
Type: Pan Head, Pan Flange Head  
Material: Case Hardened Mild Steel  
Size: M3.5, M4, M5



[www.trfastenings.com/products/product-innovation/epw-screw](http://www.trfastenings.com/products/product-innovation/epw-screw)



## Round Serrated Face Rivet Bush

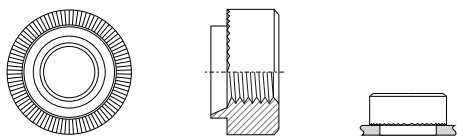

Category: Rivet Bush  
Product: Round  
Type: Serrated Face  
Material: Steel, Stainless Steel, Brass, Aluminium  
Thread: M2.5, M3, M3.5, M4, M5, M6, M8, M10, M12



[www.trfastenings.com/TR00024998](http://www.trfastenings.com/TR00024998)

## Mini Round Serrated Face Rivet Bush

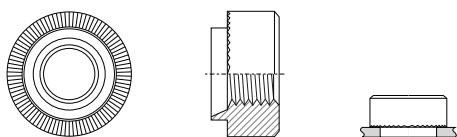

Category: Rivet Bush  
Product: Round  
Type: Mini Serrated Face  
Material: Steel, Stainless Steel, Brass, Aluminium  
Thread: M2, M2.5, M3, M3.5, M4, M5, M6, M8, M10, M12



[www.trfastenings.com/TR00023292](http://www.trfastenings.com/TR00023292)

## Round Serrated Spigot Rivet Bush

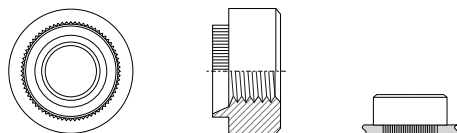

Category: Rivet Bush  
Product: Round  
Type: Serrated Spigot  
Material: Steel, Stainless Steel, Brass, Aluminium  
Thread: M2.5, M3, M3.5, M4, M5, M6, M8, M10, M12



[www.trfastenings.com/TR00025127](http://www.trfastenings.com/TR00025127)

## Hexagon Rivet Bush

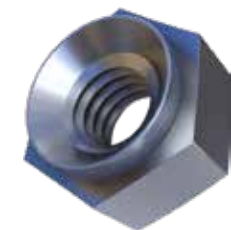
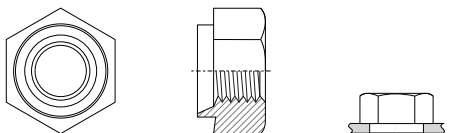

Category: Rivet Bush  
Product: Hexagon  
Type: Rivet Bush  
Material: Steel, Stainless Steel  
Thread: M2.5, M3, M3.5, M4, M5, M6, M8, M10, M12



[www.trfastenings.com/TR00023122](http://www.trfastenings.com/TR00023122)





## Mini Round Euro Rivet Bush

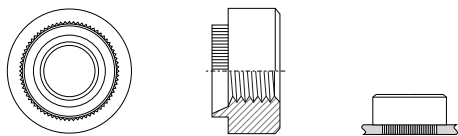

Category: Rivet Bush  
Product: Round  
Type: Mini Euro  
Material: Steel  
Thread: M3, M4, M5, M6



[www.trfastenings.com/TR00023267](http://www.trfastenings.com/TR00023267)

## Round Euro Rivet Bush

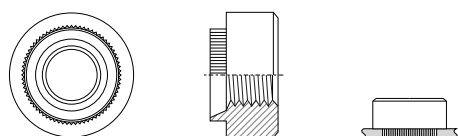

Category: Rivet Bush  
Product: Round  
Type: Euro  
Material: Steel  
Thread: M3, M4, M5, M6, M8



[www.trfastenings.com/TR00024966](http://www.trfastenings.com/TR00024966)

## Standoff Serrated Face Rivet Bush

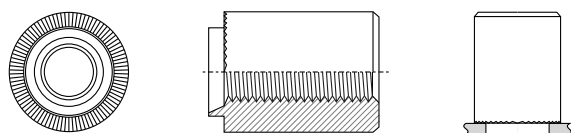

Category: Rivet Bush  
Product: Standoff  
Type: Serrated Face  
Material: Steel, Stainless Steel  
Thread: M2.5, M3, M3.5, M4, M5, M6, M8, M10, M12



[www.trfastenings.com/TR00025272](http://www.trfastenings.com/TR00025272)

## Mini Standoff Serrated Face Rivet Bush

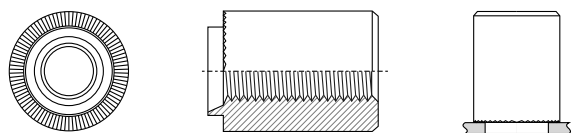

Category: Rivet Bush  
Product: Standoff  
Type: Mini Serrated Face  
Material: Steel, Stainless Steel  
Thread: M2, M2.5, M3, M3.5, M4, M5, M6, M8, M10, M12



[www.trfastenings.com/TR00023513](http://www.trfastenings.com/TR00023513)



## Tank Rivet Bush

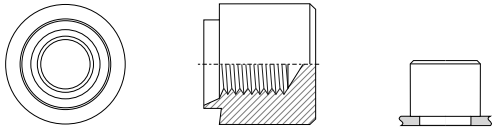

Category: Rivet Bush  
Product: Round  
Type: Tank  
Material: Steel, Stainless Steel  
Thread: M3, M4, M5, M6, M8, M10, M12



[www.trfastenings.com/TR00026646](http://www.trfastenings.com/TR00026646)

## Swage Nut Rivet Bush

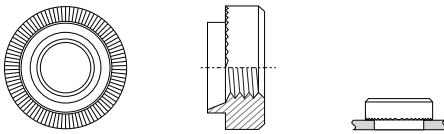

Category: Rivet Bush  
Product: Round  
Type: Swage Nut  
Material: Steel, Stainless Steel  
Thread: M3, M4, M5, M6, M8



[www.trfastenings.com/TR00026575](http://www.trfastenings.com/TR00026575)

## Hank-Loc® Round Rivet Bush

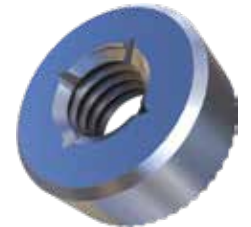
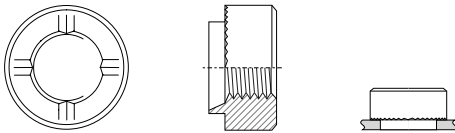

Category: Rivet Bush  
Product: Round  
Type: Hank-Loc®  
Material: Steel, Stainless Steel  
Thread: M6, M8, M10, M12



[www.trfastenings.com/TR00035689](http://www.trfastenings.com/TR00035689)

## Hank-Loc® Mini Rivet Bush

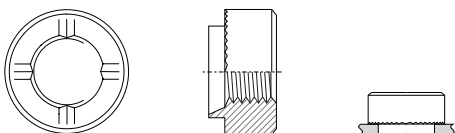

Category: Rivet Bush  
Product: Round  
Type: Mini Hank-Loc®  
Material: Steel, Stainless Steel  
Thread: M6, M8, M10, M12



[www.trfastenings.com/TR00035755](http://www.trfastenings.com/TR00035755)



Hank® is a registered trademark of TR Fastenings.  
Hank-Loc® is a registered trademark of TR Fastenings.





# Hank-Loc® Hexagon Rivet Bush

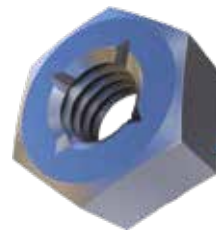
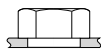
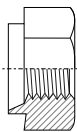
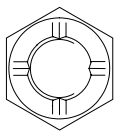

Category: Rivet Bush  
Product: Hexagon  
Type: Hank-Loc®  
Material: Steel, Stainless Steel  
Thread: M6, M8, M10, M12



[www.trfastenings.com/TR00035616](http://www.trfastenings.com/TR00035616)



## Knurled Body Reduced Head Open End

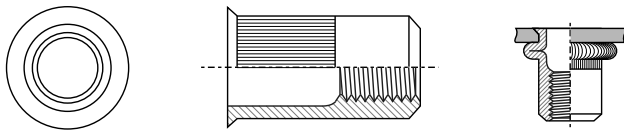

Category: Blind Rivet Nut  
Product: Reduced Head - REDE  
Type: Knurled Body - Open End  
Material: Steel, Stainless Steel  
Thread: M3, M4, M5, M6, M8, M10



[www.trfastenings.com/TR00022074](http://www.trfastenings.com/TR00022074)

## Knurled Body Reduced Head Closed End

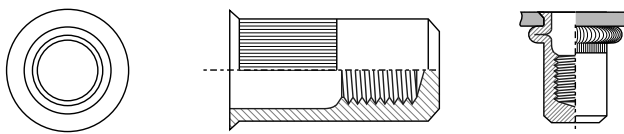

Category: Blind Rivet Nut  
Product: Reduced Head - REDE  
Type: Knurled Body - Closed End  
Material: Steel  
Thread: M4, M5, M6, M8, M10



[www.trfastenings.com/TR00045679](http://www.trfastenings.com/TR00045679)

## Plain Body Reduced Head Open End

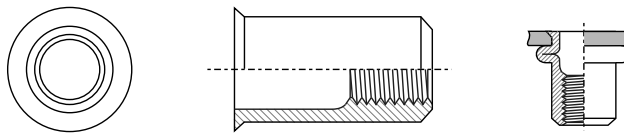

Category: Blind Rivet Nut  
Product: Reduced Head - REDE  
Type: Plain Body - Open End  
Material: Steel, Stainless Steel  
Thread: M3, M4, M5, M6, M8, M10



[www.trfastenings.com/TR00022098](http://www.trfastenings.com/TR00022098)

## Plain Body Reduced Head Closed End

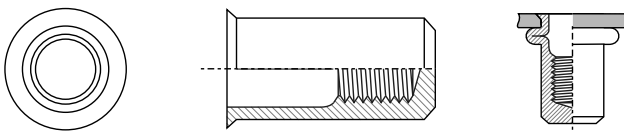

Category: Blind Rivet Nut  
Product: Reduced Head - REDE  
Type: Plain Body - Closed End  
Material: Steel  
Thread: M4, M5, M6, M8, M10



[www.trfastenings.com/TR00045685](http://www.trfastenings.com/TR00045685)





## Hexagon Body Reduced Head Open End

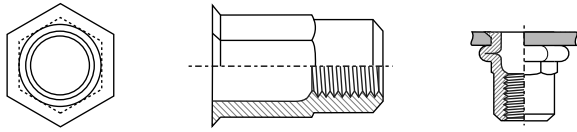

Category: Blind Rivet Nut  
 Product: Reduced Head - REDXE  
 Type: Hexagon Body - Open End  
 Material: Steel, Stainless Steel  
 Thread: M4, M5, M6, M8, M10



[www.trfastenings.com/TR00022120](http://www.trfastenings.com/TR00022120)

## Knurled Body Flange Head Open End

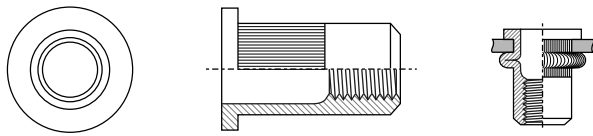

Category: Blind Rivet Nut  
 Product: Flange Head- FLG  
 Type: Knurled Body - Open End  
 Material: Steel, Stainless Steel  
 Thread: M3, M4 Medium, M4 Short, M5 Medium, M5 Short, M6 Medium, M6 Short, M8 Medium, M8 Short, M10 Medium, M10 Short, M12



[www.trfastenings.com/TR00022139](http://www.trfastenings.com/TR00022139)

## Knurled Body Flange Head Closed End

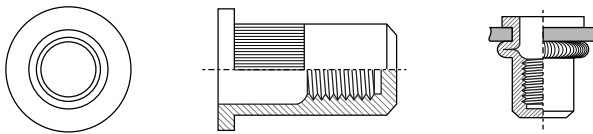

Category: Blind Rivet Nut  
 Product: Flange Head - FLG  
 Type: Knurled Body - Closed End  
 Material: Steel, Stainless Steel  
 Thread: M3, M4, M5, M6, M8, M10



[www.trfastenings.com/TR00022158](http://www.trfastenings.com/TR00022158)

## Hexagon Body Flange Head Open End

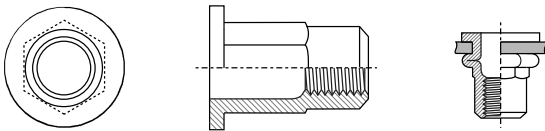

Category: Blind Rivet Nut  
 Product: Flange Head - FLGXE  
 Type: Hexagon Body - Open End  
 Material: Steel, Stainless Steel  
 Thread: M4, M5, M6, M8, M10



[www.trfastenings.com/TR00022171](http://www.trfastenings.com/TR00022171)

## Knurled Body Countersunk Head Open End

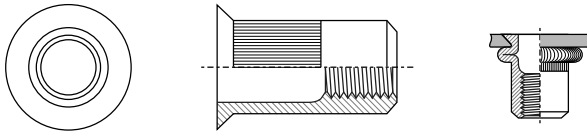

**Category:** Blind Rivet Nut  
**Product:** Countersunk Head - CSK  
**Type:** Knurled Body - Open End  
**Material:** Steel, Stainless Steel  
**Thread:** M4, M5, M6, M8, M10



[www.trfastenings.com/TR00022182](http://www.trfastenings.com/TR00022182)





## Open Type Dome Head

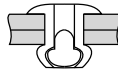
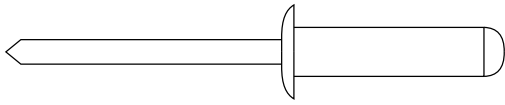

Category: Blind Rivet  
Type: Open Type  
Head: Dome Head  
Material: Aluminium (AlMg3.5/2.5/5), Steel, Stainless Steel, Copper



[www.trfastenings.com/TR00022193](http://www.trfastenings.com/TR00022193)

## Open Type Countersunk Head

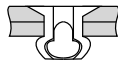
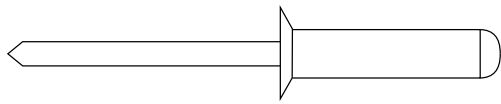

Category: Blind Rivet  
Type: Open Type  
Head: Countersunk Head  
Material: Aluminium (AlMg3.5), Steel, Stainless Steel



[www.trfastenings.com/TR00022539](http://www.trfastenings.com/TR00022539)

## Open Type Large Flange Head

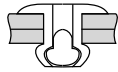
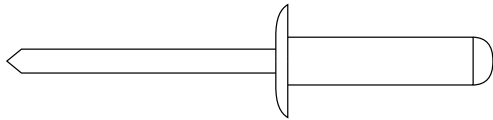

Category: Blind Rivet  
Type: Open Type  
Head: Large Flange Head  
Material: Aluminium (AlMg3.5/5), Steel, Stainless Steel



[www.trfastenings.com/TR00022678](http://www.trfastenings.com/TR00022678)

## Sealed Type Dome Head

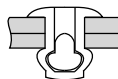
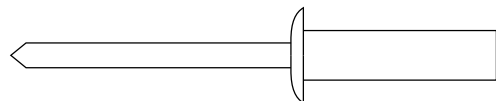

Category: Blind Rivet  
Type: Sealed Type  
Head: Dome Head  
Material: Aluminium (AlMg5), Steel, Stainless Steel, Copper



[www.trfastenings.com/TR00022813](http://www.trfastenings.com/TR00022813)



## Sealed Type Countersunk Head

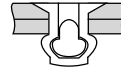
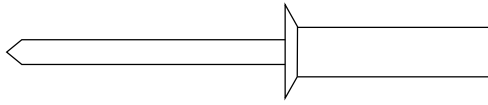

Category: Blind Rivet  
Type: Sealed Type  
Head: Countersunk Head  
Material: Aluminium (AlMg5), Steel



[www.trfastenings.com/TR00022932](http://www.trfastenings.com/TR00022932)

## Sealed Type Large Flange Head

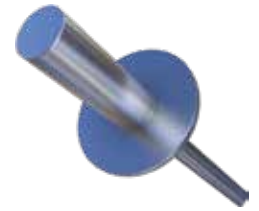
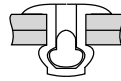
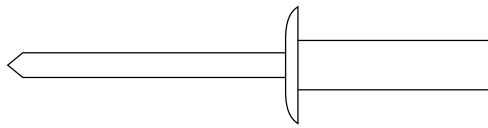

Category: Blind Rivet  
Type: Sealed Type  
Head: Large Flange Head  
Material: Aluminium (AlMg5), Steel, Stainless Steel



[www.trfastenings.com/TR00022949](http://www.trfastenings.com/TR00022949)

## Multi-Grip Type Dome Head

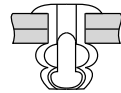
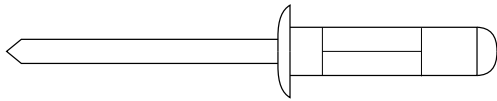

Category: Blind Rivet  
Type: Multi-Grip Type  
Head: Dome Head  
Material: Aluminium, Steel, Stainless Steel



[www.trfastenings.com/TR00022969](http://www.trfastenings.com/TR00022969)

## Multi-Grip Type Countersunk Head

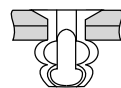
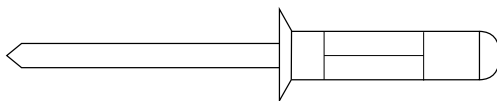

Category: Blind Rivet  
Type: Multi-Grip Type  
Head: Countersunk Head  
Material: Aluminium, Steel



[www.trfastenings.com/TR00023030](http://www.trfastenings.com/TR00023030)

## Multi-Grip Type Large Flange Head

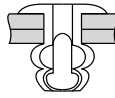
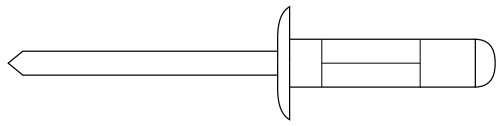

Category: Blind Rivet  
Type: Multi-Grip Type  
Head: Large Flange Head  
Material: Aluminium, Steel



[www.trfastenings.com/TR00023056](http://www.trfastenings.com/TR00023056)

## Peel Type Dome Head

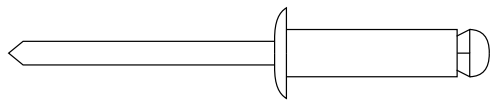

Category: Blind Rivet  
Type: Peel Type  
Head: Dome Head  
Material: Aluminium, Steel



[www.trfastenings.com/TR00023080](http://www.trfastenings.com/TR00023080)

## Grooved Type Dome Head

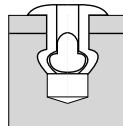
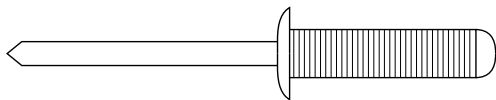

Category: Blind Rivet  
Type: Grooved Type  
Head: Dome Head  
Material: Aluminium (AlMg3.5), Steel



[www.trfastenings.com/TR00023103](http://www.trfastenings.com/TR00023103)



## Hexagon Weld Nut

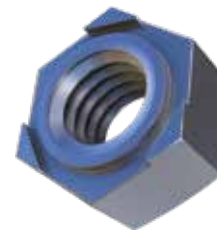
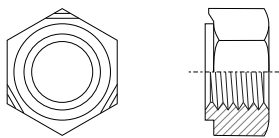

Category: Weld Nut  
Type: Hexagon  
Standard: DIN 929  
Material: Steel, Stainless Steel, A4 Stainless Steel  
Thread: M3, M4, M5, M6, M8, M10, M12, M14, M16



[www.trfastenings.com/TR00001213](http://www.trfastenings.com/TR00001213)

## Square Weld Nut

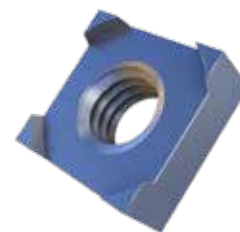
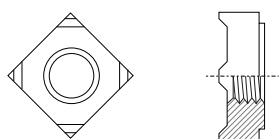

Category: Weld Nut  
Type: Square  
Standard: DIN 928  
Material: Steel, Stainless Steel  
Thread: M4, M5, M6, M8, M10, M12



[www.trfastenings.com/TR00001237](http://www.trfastenings.com/TR00001237)

## Wun-Loc® Self Locking Weld Nut

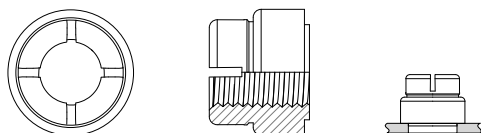

Category: Weld Nut  
Type: Wun-Loc® Self Locking  
Material: Steel  
Thread: M4, M5, M6, M8, M10, M12



[www.trfastenings.com/TR00035601](http://www.trfastenings.com/TR00035601)



## K-Series® Nut

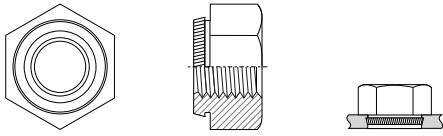

Category: Nut  
Product: K-Series®  
Type: Hexagon  
Material: Steel, Stainless Steel  
Thread: M2.5, M3, M4, M5, M6, M8, M10, M12, M16, M20

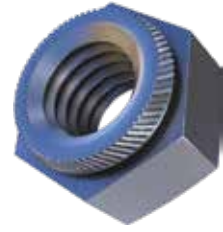

[www.trfastenings.com/TR00035866](http://www.trfastenings.com/TR00035866)

## K-Series® Thin Nut

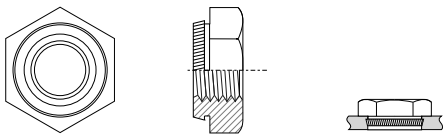

Category: Nut  
Product: K-Series® Thin  
Type: Hexagon  
Material: Steel  
Thread: M8, M10, M12



[www.trfastenings.com/TR00046717](http://www.trfastenings.com/TR00046717)



## Threaded CD Weld Stud

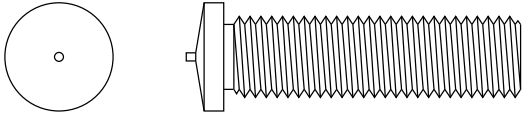

Category: CD Weld Stud  
Type: Threaded  
Standard: DIN EN ISO 13918  
Material: Steel, Stainless Steel, Aluminium  
Thread: M3, M4, M5, M6, M8



[www.trfastenings.com/TR00036039](http://www.trfastenings.com/TR00036039)

## Unthreaded CD Weld Stud

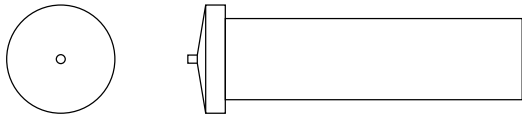

Category: CD Weld Stud  
Type: Unthreaded  
Standard: DIN EN ISO 13918  
Material: Steel, Stainless Steel  
Width: 3mm, 4mm, 5mm, 6mm, 7.1mm



[www.trfastenings.com/TR00036189](http://www.trfastenings.com/TR00036189)

## Internally Threaded CD Weld Stud

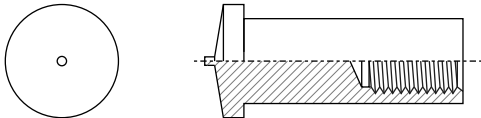

Category: CD Weld Stud  
Type: Internally Threaded  
Standard: DIN EN ISO 13918  
Material: Steel  
Thread: M3, M4, M5



[www.trfastenings.com/TR00036252](http://www.trfastenings.com/TR00036252)

## Coarse Threaded CD Weld Stud

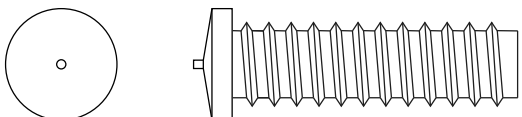

Category: CD Weld Stud  
Type: Coarse Threaded  
Standard: DIN EN ISO 13918  
Material: Steel  
Width: 5mm



[www.trfastenings.com/TR00036273](http://www.trfastenings.com/TR00036273)



## Masking Caps

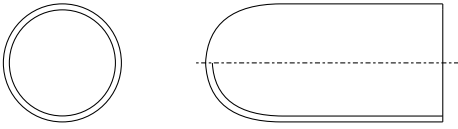

Category: Masking Caps and Plugs  
Product: Cap  
Material: Silicon  
To Suit: M3, M4, M5, M6, M8



[www.trfastenings.com/TR00038867](http://www.trfastenings.com/TR00038867)

## Masking Plugs

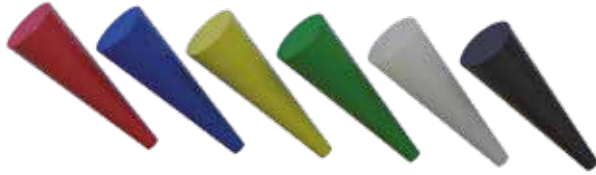
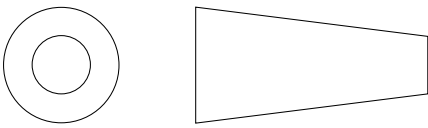

Category: Masking Caps and Plugs  
Product: Plug  
Material: Silicon  
To Suit: M3, M3/M4, M4/M5/M6, M6/M8, M8, M8/M10



[www.trfastenings.com/TR00038879](http://www.trfastenings.com/TR00038879)





## Cage Nut

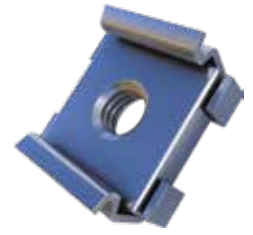
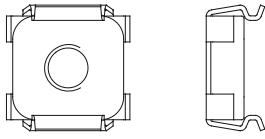

Category: Spring Steel Fasteners  
Product: Nut  
Type: Cage  
Material: Steel  
Thread: M4, M5, M6, M8, M10



[www.trfastenings.com/TR00035907](http://www.trfastenings.com/TR00035907)

## U Nut

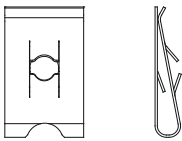

Category: Spring Steel Fasteners  
Product: Nut  
Type: U  
Material: Steel  
Thread: 2.9mm (no.4), 3.5mm (no.6), 4.2mm (no.8), 4.8mm (no.10), 5.5mm (no.12), 6.3mm (no.14), 7.0mm (no.16)



[www.trfastenings.com/TR00035935](http://www.trfastenings.com/TR00035935)

## J Nut

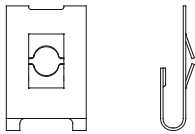

Category: Spring Steel Fasteners  
Product: Nut  
Type: J  
Material: Steel  
Thread: 3.5mm (no.6), 4.2mm (no.8), 4.8mm (no.10), 5.5mm (no.12), 6.3mm (no.14)



[www.trfastenings.com/TR00035920](http://www.trfastenings.com/TR00035920)

## Flat Nut

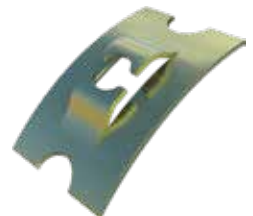
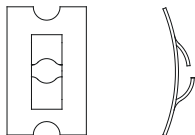

Category: Spring Steel Fasteners  
Product: Nut  
Type: Flat  
Material: Steel  
Thread: 3.5mm (no.6), M4, 4.2mm (no.8), M5, M6, 6.3mm (no.14)



[www.trfastenings.com/TR00035990](http://www.trfastenings.com/TR00035990)



## Torque Nut

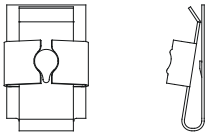

Category: Spring Steel Fasteners  
Product: Nut  
Type: Torque  
Material: Steel  
Thread: 3.5mm (no.6), 4.2mm (no.8), 4.8mm (no.10), 5.5mm (no.12), 6.3mm (no.14)

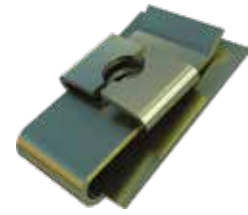

[www.trfastenings.com/TR00035978](http://www.trfastenings.com/TR00035978)

## Multi Thread U Nut

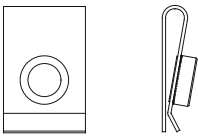

Category: Spring Steel Fasteners  
Product: Nut  
Type: Multi Thread U  
Material: Steel  
Thread: M3, M4, M5, M6, M8, M10, M12

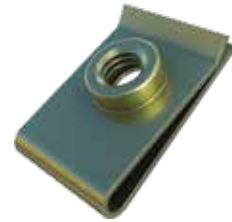

[www.trfastenings.com/TR00036000](http://www.trfastenings.com/TR00036000)



## Round Head Solid Rivet

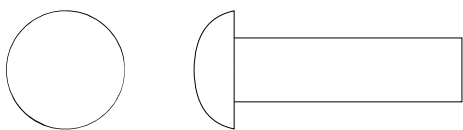

Category: Solid & Tubular Rivets  
Product: Round Head  
Type: Solid  
Material: Steel, Stainless Steel, Aluminium, Copper  
Standard: DIN 124



[www.trfastenings.com/TR00030337](http://www.trfastenings.com/TR00030337)

## Flat Round Head Solid Rivet

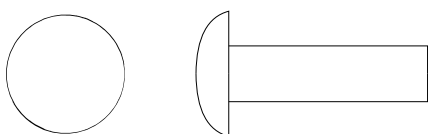

Category: Solid & Tubular Rivets  
Product: Flat Round Head  
Type: Solid  
Material: Steel, Aluminium, Copper  
Standard: DIN 674



[www.trfastenings.com/TR00030257](http://www.trfastenings.com/TR00030257)

## Countersunk Head Solid Rivet

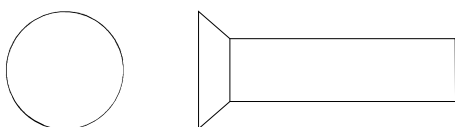

Category: Solid & Tubular Rivets  
Product: Countersunk Head  
Type: Solid  
Material: Stainless Steel  
Standard: DIN 661



[www.trfastenings.com/TR00030242](http://www.trfastenings.com/TR00030242)

## Tubular Rivet

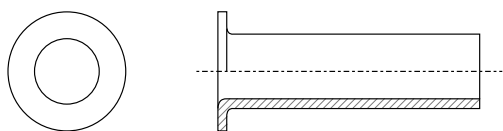

Category: Solid & Tubular Rivets  
Product: Tubular  
Type: Tubular  
Material: Brass  
Standard: DIN 7340A



[www.trfastenings.com/TR00030514](http://www.trfastenings.com/TR00030514)



# TR - Full Service Provider

## Services



TR Fastenings is part of Trifast plc and is an international specialist in the design, engineering, manufacture and distribution of high quality industrial and Cat C fastenings principally to major global assembly industries.

TR has 32 business locations within the UK, Asia, Europe and the USA including: eight high volume, high-quality and cost-effective manufacturing sites. TR's manufacturing network represents a third of the Group's business.

## Industries



TR Fastenings supplies components to over 5,000 companies globally across a wide range of industries, including automotive, electronics, domestic appliances and telecoms.

As a full-service provider to multinational OEMs and Tier 1 companies, TR delivers comprehensive support to its customers across every requirement, from concept design through to technical engineering consultancy, manufacturing, supply management and global logistics.

## Manufacturing



TR has a manufacturing network in Europe and Asia specialising in producing high volume parts specifically to customer drawings. TR's factories are strategically placed geographically to provide cost efficient product to very high quality standards.

TR Quality Accreditations:

- ISO 9001
- IATF 16949
- ISO 14001

## Global Website



[www.trfastenings.com](http://www.trfastenings.com) is designed to be the ultimate go-to resource for engineers, designers and buyers.

- Over 50,000 products
- 2D/3D fastener models
- Animated installation guides
- Tooling requirements and technical information
- Detailed performance data
- Material and finish specifications
- Fastener standards and comparison tables



## TR - Product Range

### Standard Fasteners



We stock and supply a vast range of standard fasteners to DIN, ISO & ANSI standards including:

- Machine screws
- Self tapping screws
- Thread forming screws
- Socket products
- Nuts
- Washers

### Fasteners for Plastic



**Screws for plastic**  
Plas-tech® 30  
Plas-fix® 45 + 60  
Thread cutting Type BT + Y  
Hi-lo thread  
JCIS P-type M1.4 to M2.6  
JCIS B-type M1.4 to M2.6

**Inserts for plastic**  
Sonic-sert  
Heat-sert  
Broaching-sert  
Expansion-sert  
Tech-sert  
Many more ...

### Plastic Hardware



**Circuit board hardware**  
Cable management  
Rivets  
Machine screws  
Threaded spacers  
Threaded pillars  
Nuts  
Through spacers  
Washers  
Bumpers

**Masking caps and plugs**

### Spacers and Pillars



**Threaded spacers**  
Hexagon female-female  
Round female-female

**Through spacers**

**Threaded pillars**  
Hexagon male-female  
Hexagon male-male  
Round male-female  
Hexagon self tapping  
male-female



## TR - Product Range

### Security Fasteners

---



Machine screws  
Self tapping screws  
Wood screws  
Self drilling screws  
Nuts

One way cross recess  
Oval  
Triangular  
One way slot  
Many more ...

Drive types:  
Pin hexagon  
Pin recess Torx® drive  
2 hole

### Enclosure Hardware

---



Locking systems  
Locks  
Lock components  
Hinges  
Latches  
Clamps  
Terminals  
Gaskets  
Handles  
Accessories

### Tooling and Driver Bits

---



Standard driver bits  
Hexagon - short/long  
PoziDriv® - short/long  
H drive - short/long  
Torx® - short/long

Security drivers

Standard driver keys  
Hexagon  
Hexagon with pilot  
Torx®

### Bespoke Products

---



Our factories in Asia and Europe produce components which are specifically tailored to customer drawings.

In addition, our strategic partnerships with other world-class manufacturers, allow us to offer a wide range of practically any size of turned, cold-formed, pressed or moulded components.







**UK**  
t: +44 (0)8454 811 800 f: +44 (0)870 458 7851  
e-mail: uk@trfastenings.com

**Ireland**  
t: +353 (0)22 22301 f: +353 (0)22 22056  
e-mail: ireland@trfastenings.com

**Netherlands**  
t: +31 (0)541 511515 f: +31 (0)541 517134  
e-mail: netherlands@trfastenings.com

**Norway**  
t: +47 67 06 70 00 f: +47 67 06 70 10  
e-mail: norway@trfastenings.com

**Sweden**  
t: +46 (0)8 578 44 900 f: +46 (0)8 578 44 950  
e-mail: sweden@trfastenings.com

**Spain**  
t: +34 93 647 22 45  
e-mail: spain@trfastenings.com

**Hungary**  
t: +36 (06)24 516970 f: +36 (06)24 516961  
e-mail: hungary@trfastenings.com

**Poland - Representative**  
t: +48 (22)402 36 14 f: +48 (22)402 36 24  
e-mail: poland@trfastenings.com

**Italy**  
t: +39 (0)75 9149015 f: +39 (0)75 9190165  
e-mail: info@trvic.it

**Germany**  
t: +49 (0) 5246 . 50320 - 0 f: +49 (0) 5246 . 50320 - 70  
e-mail: info@trkuhlmann.com

**Slovakia - Representative**  
m: +421(0)911 012 016  
e-mail: slovakia@trfastenings.com

**USA**  
t: +1 800-280-2181 f: +1 281-807-0620  
e-mail: usa@trfastenings.com

**Singapore**  
t: +65 6759 6033 f: +65 6759 6022  
e-mail: singapore@trfastenings.com

**Malaysia**  
t: +6 (03) 5519 1444 f: +6 (03) 5510 8505  
e-mail: psep@psep.com.my

**China**  
t: +86 21 5032 5696 f: +86 21 5032 5775  
e-mail: china@trfastenings.com

**Taiwan**  
t: +886 7 557 6366 f: +886 7 557 1977  
e-mail: taiwan@trfastenings.com

**Philippines - Representative Office**  
t: +63-25768476  
e-mail: philippines@trfastenings.com

**India**  
t: +91 (0)44 4280 3932  
e-mail: india@trfastenings.com

**Thailand**  
t: +66(0)2 130 6562 f: +66(0)2 130 7603  
e-mail: thailand@trfastenings.com

**Japan - Representative**  
t: +81(0)70 4467 1118  
e-mail: japan@trfastenings.com

## Technical and Innovation Centres

**Birmingham - UK**  
t: +44 (0)121 521 0100 f: +44 (0)121 521 0101  
e-mail: wednesbury@trfastenings.com

**Gothenburg - Sweden**  
t: +46 (0)31 31 760 776 f: +46 (0)8 578 44 950  
e-mail: sweden@trfastenings.com

**CUICAR - South Carolina USA**  
t: +1 800 280 2181 f: +1 281 807 0620  
e-mail: usa@trfastenings.com

[sales@trfastenings.com](mailto:sales@trfastenings.com)

[www.trfastenings.com](http://www.trfastenings.com)

[info@trfastenings.com](mailto:info@trfastenings.com)



Master Distributor Details